



kurtaran

FIXED INLINE INDUCTOR

Kurtaran Fixed In-line Inductors are designed primarily for use in fixed foam systems and provide a simple and reliable method of proportioning foam concentrate in constant flow applications.

The range comprises six basic models and performance extends from 65 to 4,000 litres per minute at inlet pressures of between 4 and 16 bar as shown overleaf. Within these limits, the induction rate can be set accurately between %1 - %6.

Body is manufactured from stainless steel with polyester internals. The units have very good corrosion resistance and are suitable for use in the most extreme environmental conditions.

Each inductor is factory calibrated to match the specific requirements of the system into which it is to be installed. Following parameters are required at the order stage to calibrate the unit accurately:

- (a) Required foam solution flow
- (b) Water inlet pressure to Inductor
- (c) Foam type, concentration ratio and ambient pressure
- (d) Maximum suction lift
- (e) Suction pipe length and internal diameter.

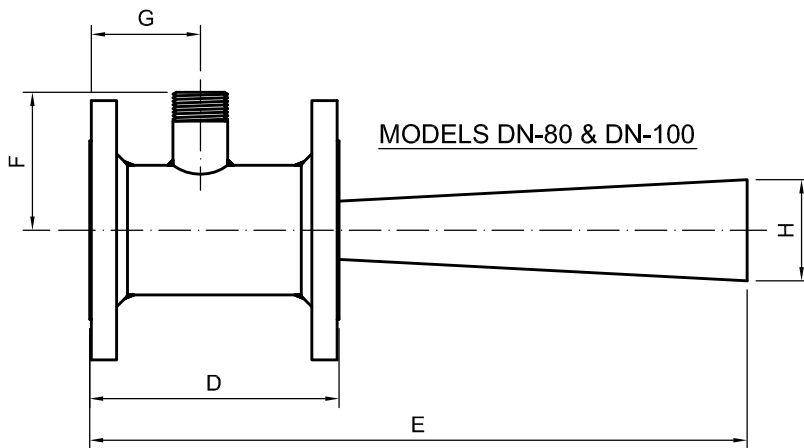

MODELS DN-25, DN-40, DN-50 & DN-65

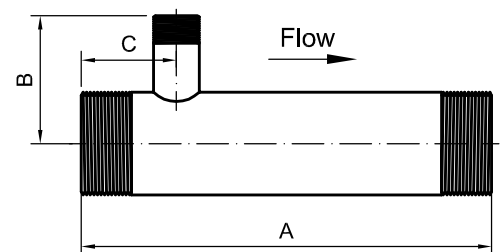

(DN-100 FIXED INLINE INDUCTOR)

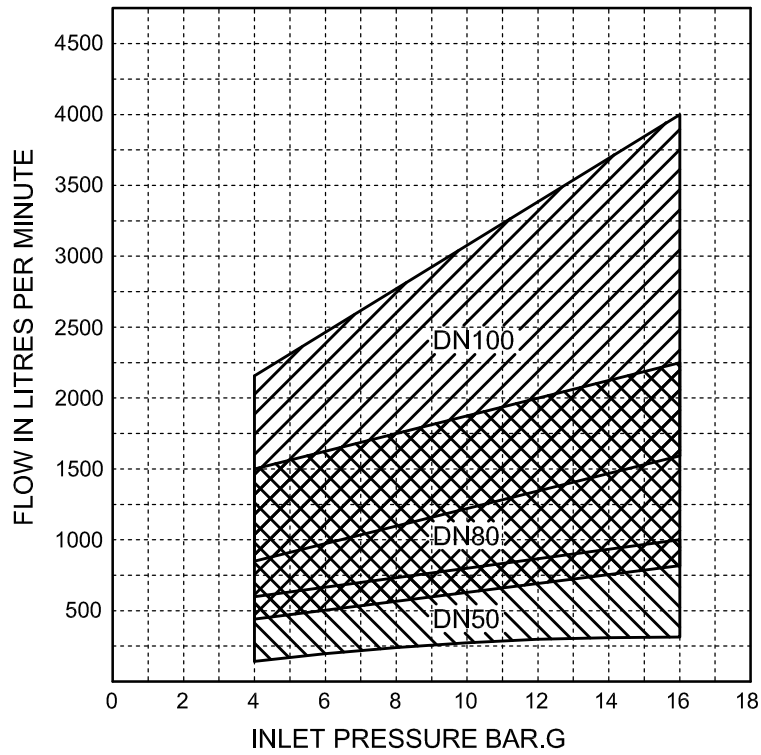
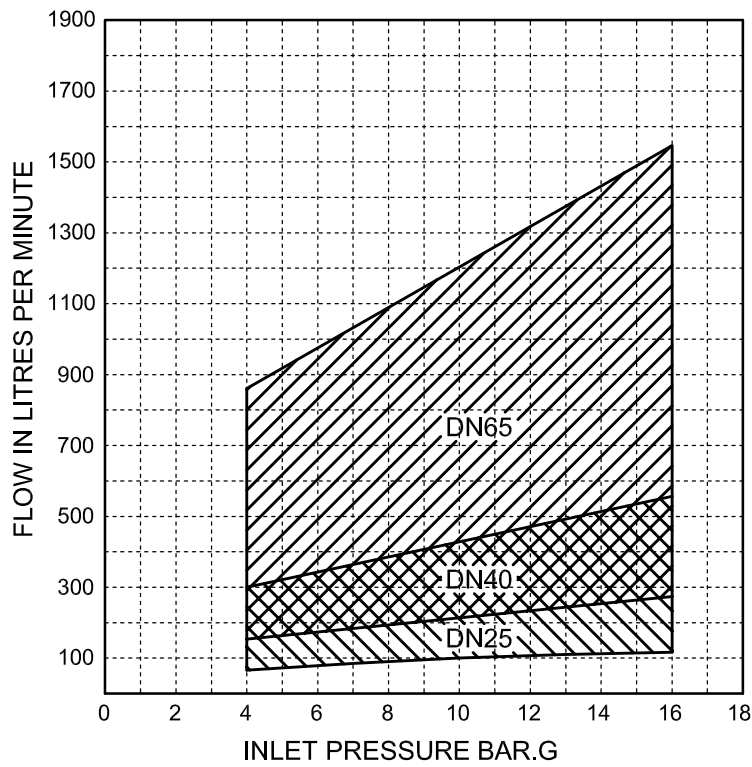

These graphs above are for guidance only. Before final selection of the inductor size, system parameters a-e should be verified by us (especially where foam pick-up heights exceed 2 metres and induction rates of %6 are required).

Up to %65 of the inlet pressure at the inductor (within the limits shown above) is available to power foam generating equipment, to overcome pipework friction losses and/or to overcome static head. Provided the back-pressure caused by the system configuration downstream from the inductor does not exceed this, foam induction accuracy will be maintained.

To ensure accurate proportioning, the suction lift and foam pick-up pipe length should be minimised and the water supply diameter should not be less than that of the inductor.

The flow characteristics of a non-return valve fitted to the foam pick-up have to be allowed when calibrating the inductor and when required, the unit must be supplied by "Doğan Yangın". If a non-return valve is not used, it is recommended that a full bore on/off valve is fitted.

	DN-25	DN-50	DN-65	DN-80	DN-100
DIMENSION A (mm)	100	320	365	-	-
B (mm)	50	70	85	-	-
C (mm)	45	50	67	-	-
D (mm)	-	-	-	185	220
E (mm)	-	-	-	470(max)	550(max)
F (mm)	-	-	-	100	125
G (mm)	-	-	-	80	91
H (mm)	-	-	-	63 (dia)	81 (dia)
CONNECTIONS	1" BSP	2" BSP	2½" BSP	3" R.F. Flanged*	4" R.F. Flanged*
FOAM INLET	½" BSP	¾" BSP	1" BSP	1½" BSP	1½" BSP
MATERIALS	304 Stainless Steel with Polyester internal fittings				
FINISH	Natural Finish				

* Flanges are DIN-PN16 R.F standard. Upon request, the unit can be manufactured with ANSI B16.5 #150 R.F. flanged. Please specify flange standart at the order stage.

The right is reserved to vary or modify any specification without prior notice.



DOĞAN YANGIN
SÖNDÜRME SAN. ve TİC. A.Ş.

Perşembepazarı Cad. No:13/C Karaköy - İSTANBUL
Tel: 0212.249 4922 Faks: 0212.245 3287
e-posta: info@dys.com.tr